

NAXOS Series

PROFESSIONAL POWERED LOUDSPEAKER

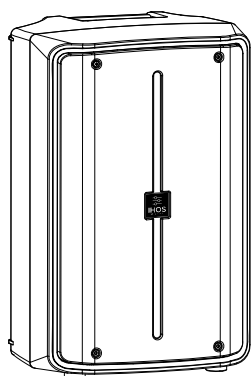

NAXOS 10A DSP

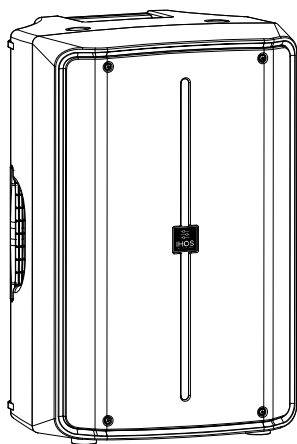

NAXOS 12A DSP

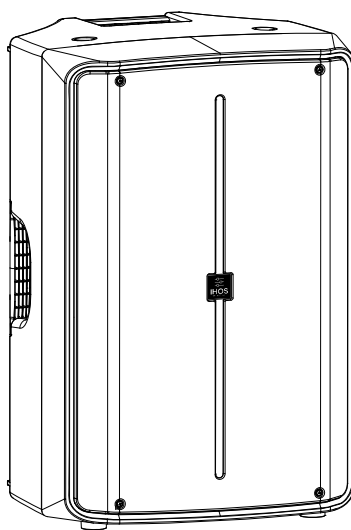

NAXOS 15A DSP

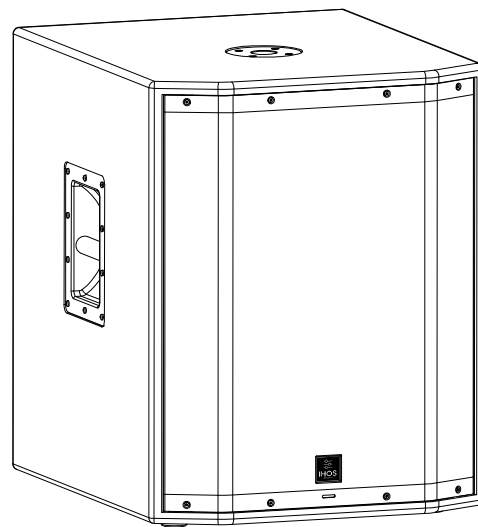

NAXOS 18A SUB

Introduction

Thank you for choosing this NAXOS Series powered loudspeaker. The NAXOS Series offer a level of build quality and features intended to provide the best possible performance for a wide range of user applications. From the detail required to faithfully reproduce classical music, to the low frequency response, power and clarity demanded by dance music, the NAXOS Series will not disappoint.

Please fully read this manual regarding all safety warnings, advice and available features in order to safely get the best possible performance for your intended application. Please retain this manual for future reference.

Main Features

Lightweight, tough and durable high performance polymer cabinet.

Three mixed inputs with Line/Mic TRS, XLR and 3.5 Mini Jack connectivity.

Bluetooth 5.0 with True Wireless Stereo (TWS) linking capability.

DSP with Limiter for system overload protection and optimum audio clarity.

Soft start switched mode supply for maximum power and efficiency.

Combined class bi-amplified system with D driven low and AB driven high frequency for low distortion reproduction.

Free standing upright, stage monitor or pole mountable cabinet design.

Package contents

1 X Powered speaker cabinet

1 X AC Power cord

Important Safety Instructions

NAXOS Series loudspeakers have been designed and constructed to comply with all applicable safety regulations for their intended country of use. However, the advice in this manual must be followed in order to maintain safety. Failure to do so may result in damage to the speaker, to other equipment, personal injury, electric shock, or death. The manufacturer accepts no liability for any consequences resulting from failure to follow this advice.

IMPORTANT



The lightning flash with arrowhead symbol, within an equilateral triangle, is intended to alert the user to the presence of uninsulated "dangerous voltage" within the product's enclosure that may be of sufficient magnitude to constitute a risk of electric shock to persons.



CAUTION:
TO PREVENT THE RISK OF ELECTRIC SHOCK, DO NOT REMOVE COVER (OR BACK). NO USER-SERVICEABLE PARTS INSIDE. REFER SERVICING TO QUALIFIED SERVICE PERSONNEL.



The exclamation point within an equilateral triangle is intended to alert the user to the presence of important operating and maintenance (servicing) instructions in the literature accompanying the appliance.

IMPORTANT SAFETY INSTRUCTIONS

- 1) Read these instructions.
- 2) Keep these instructions.
- 3) Heed all warnings.
- 4) Follow all instructions.
- 5) Do not use this apparatus near water.
- 6) Clean only with dry cloth.
- 7) Do not block any ventilation openings. Install in accordance with the manufacturer's instructions.
- 8) Do not install near any heat sources such as radiators, heat registers, stoves, or other apparatus (including amplifiers) that produce heat.
- 9) Do not defeat the safety purpose of the polarized or grounding-type plug. A polarized plug has two blades with one wider than the other. A grounding type plug has two blades and a third grounding prong. The wide blade or the third prong are provided for your safety. If the provided plug does not fit into your outlet, consult an electrician for replacement of the obsolete outlet.
- 10) Protect the power cord from being walked on or pinched particularly at plugs, convenience receptacles, and the point where they exit from the apparatus.
- 11) Only use attachments/accessories specified by the manufacturer.
- 12) Use only with the cart, stand, tripod, bracket, or table specified by the manufacturer, or sold with the apparatus. When a cart is used, use caution when moving the cart/apparatus combination to avoid injury from tip-over.
- 13) Unplug this apparatus during lightning storms or when unused for long periods of time.
- 14) Refer all servicing to qualified service personnel. Servicing is required when the apparatus has been damaged in any way, such as power-supply cord or plug is damaged, liquid has been spilled or objects have fallen into the apparatus, the apparatus has been exposed to rain or moisture, does not operate normally, or has been dropped.



PLEASE READ CAREFULLY BEFORE PROCEEDING

Please keep this manual in a safe place for future reference.

WARNING

Always follow the basic precautions listed below to avoid the possibility of serious injury or even death from electrical shock, short-circuiting, damages, fire or other hazards. These precautions include, but are not limited to, the following:

Only use the voltage specified as correct for the device. The required voltage is printed on the name plate of the device.

Use only the included power cord.

Do not place the power cord near heat sources such as heaters or radiators, do not excessively bend or otherwise damage the cord, place heavy objects on it, or place it in a position where anyone could walk on, trip over, or roll anything over it.

Do not open the device or attempt to disassemble the internal parts or modify them in any way. The device contains no user-serviceable parts. If it should appear to be malfunctioning, discontinue use immediately and have it inspected by qualified service personnel.

Do not open the device or attempt to disassemble the internal parts or modify them in any way. The device contains no user-serviceable parts. If it should appear to be malfunctioning, discontinue use immediately and have it inspected by qualified service personnel.

Do not expose the device to rain, use it near water or in damp or wet conditions, or place containers on it containing liquids which might spill into any openings.

Never insert or remove an electric plug with wet hands.

If the power cord or plug becomes frayed or damaged, there is a sudden loss of sound during use of the device, or any unusual smells or smoke should appear, turn off the power switch, disconnect the electric plug from the outlet immediately, and have the device inspected by qualified service personnel.

If this device is dropped or damaged, immediately turn off the power switch, disconnect the electric plug from the outlet, and have the device inspected by qualified service personnel.

Additional safety advice

- Never force or push any objects into any of the receptacles or openings of the Loudspeaker other than the correct connector.
- Do not power NAXOS Loudspeakers from a generator or inverter.
- High powered loudspeaker systems can produce excessive sound levels which can cause permanent hearing damage or hearing loss. Exposure to such sound levels at close proximity or at levels which feel uncomfortable for extended periods should be avoided.
- Before connecting AC power or any external equipment to the loudspeaker, ensure that all controls are set to their minimum positions.
- NAXOS Series loudspeakers are capable of reproducing considerable bass (low frequencies) which can cause gradual movement or creeping of the speaker cabinet at high volume levels and could result in the loudspeaker falling. If used on a raised, low friction surface such as a stage or table, we strongly recommend that the loudspeaker cabinet is placed on a non-slip mat or secured to prevent such movement.

Remove the electric plug from the outlet when the device is not to be used for extended periods of time, or during electrical storms.

When removing the electric plug from the device or an outlet, always hold the plug itself and not the cord. Pulling by the cord can damage it.

When transporting or moving the device, always use two or more people. Attempting to lift the device by yourself may damage your back, result in other injury, or cause damage to the device itself.

Before moving the device, remove all connected cables.

When setting up the device, make sure that the AC outlet you are using is easily accessible. If some trouble or malfunction occurs, immediately turn off the power switch and disconnect the plug from the outlet.

Do not use the device in a confined, poorly ventilated location. Make sure that there is adequate space between the mixer and surrounding walls or other devices: at least 1' ft. at the side, 1' ft. behind and 1' ft. above. If the device is to be used installed into the speaker cabinet, make sure to allow adequate space between the speaker and the surrounding walls or other devices: at least 1' ft. at the sides, 1' ft. behind and 1' ft. above. Inadequate ventilation can result in overheating, possibly causing damage to the device(s), or even fire.

Do not use the speaker's handles for suspended installation. Doing so could result in damage or personal injury.

Avoid setting all equaliser controls to their maximum. Doing so may cause feedback and may damage the speakers.

Do not expose the device to excessive dust or vibrations, or extreme cold or heat (such as in direct sunlight, near a heater, or in a car during the day) to prevent the possibility of panel cabinet deformation or damage to the internal components.

Do not place the device in an unstable position where it might accidentally fall over.

Do not use the device in the vicinity of a TV, radio, stereo equipment, mobile phone, or other electronic devices. Doing so may result in noise, both in the loudspeaker itself and in the TV or radio next to it.

Before connecting the device to other devices, turn off the power for all devices. Before turning the power on or off for all devices, set all volume levels to minimum.

Use only the AC cord supplied. Use of other types of AC cords may result in damage to the device(s), or even fire.

When turning on the AC power in your audio system, always turn on the device LAST, to avoid speaker damage. When turning the power off, the device should be turned off FIRST for the same reason.

Do not insert your fingers or hands in any gaps or openings on the device (vents, ports, etc.).

Avoid inserting or dropping foreign objects (paper, plastic, metal, etc.) into any gaps or openings on the device (vents, ports, etc.). If this happens, turn off the power immediately and unplug the power cord from the AC outlet. Then have the device inspected by qualified service personnel.

Do not use the device for a long period of time at a high or uncomfortable volume level, since this can cause permanent hearing loss. If you experience any hearing loss or ringing in the ears, consult a physician immediately.

Do not operate the device if the sound is distorting. Prolonged use in this condition could cause overheating and result in fire.

Do not rest your weight on the device or place heavy objects on it, and avoid use excessive force on the buttons, switches or connectors.

Interference From Cell Phone

Using a cell phone near the speaker system can induce noise. If this occurs, move the cell phone further away from the speaker system.

Air blowing out of the bass reflex ports is normal with heavy bass content.

Always turn the power off when the device is not in use. The performance of components with moving contacts, such as switches, volume controls and connectors can deteriorate over time. Consult qualified service personnel about replacing defective parts.

Ventilation

When positioning or installing this unit, be sure to leave space (30cm on all sides) around the unit to allow heat dissipation.

Operating Environment

Operating environment temperature and humidity.
+5 degree C ~ +35 degree C; less than 85% RH

Power cord – Caution⚠

The power cord must be disconnected only by holding the plug. Do not pull out the plug by tugging the cord. **Never touch the power cord with wet hands as this could result in electric shock!**

Establishing a safe listening level

- Begin by setting the volume control to a low level
- Slowly increase the sound until a comfortable and clear level is reached without distortion.

Caution⚠

The POWER switch on the unit will not completely disconnect it from the AC supply. For complete isolation from the AC supply, the unit must be disconnected from the AC outlet and should therefore be positioned or installed to allow access to the AC power connection in the event of an emergency. To minimise fire hazard, the power cord should also be disconnected from the AC outlet when the unit is left unused for any extended period of time.

This product contains no user-serviceable parts. No attempt must be made to open, repair or modify this item yourself as this will invalidate the warranty and compromise safety.

Service

In the unlikely event of a suspected fault, in the first instance, always consult this manual to eliminate user error. If you require further information, technical support or service, please contact your supplying dealer or distributor, or email sales@i-hos.eu

NAXOS 10/12/15A DSP

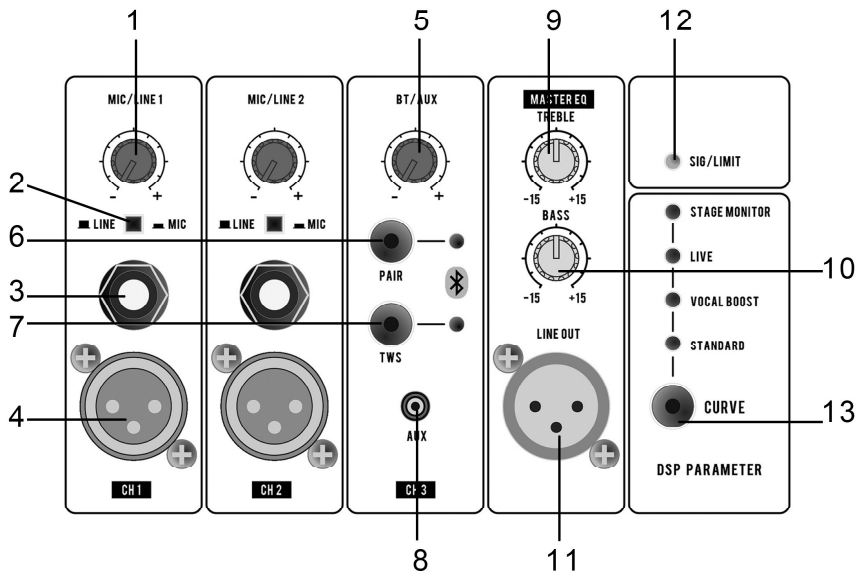

1. Mic / Line input levels
2. Mic / Line input mode selector buttons
3. TRS Jack inputs (line / mic)
4. Balanced XLR Inputs (line / mic)
5. Bluetooth / Auxiliary level
6. Bluetooth pairing button
7. TWS Connect button
8. Aux 3.5mm mini jack line input
9. Master EQ Treble level
10. Master EQ Bass level
11. Balanced XLR line output
12. Signal / Limit indicator
Green - Signal
Red - Overload warning
13. Preset DSP parameter control

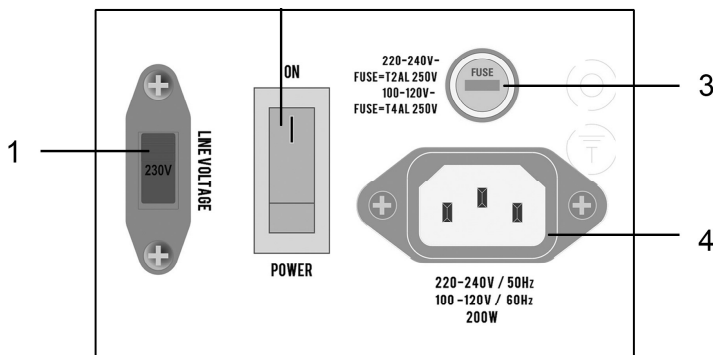

1. AC Input voltage selector
CAUTION: Do not touch
Consult user manual
2. Power on - off switch
3. AC Input fuse
4. AC Input connector

NAXOS 18A SUB

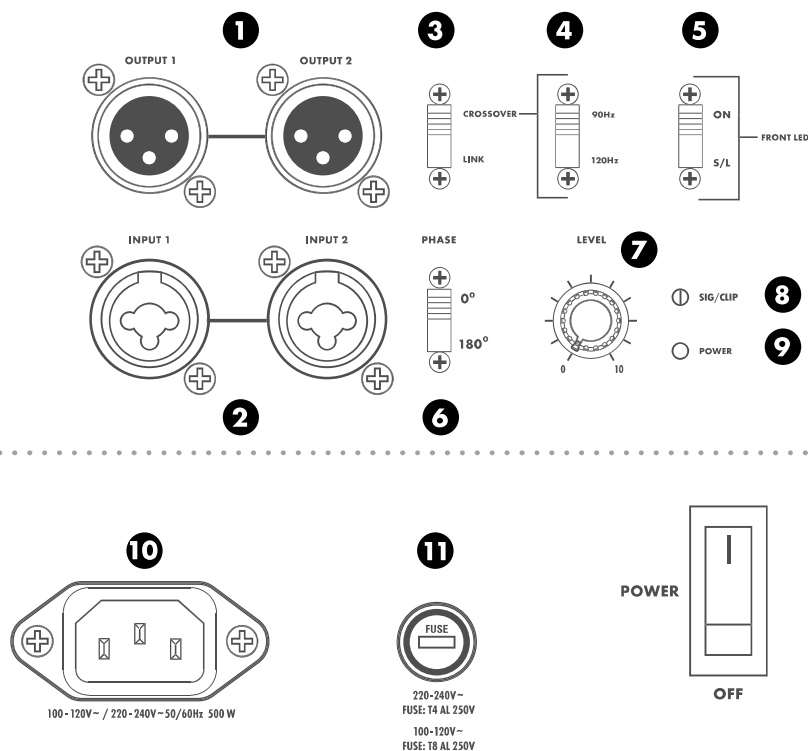

1 OUTPUTS 1 AND 2

When set to Crossover, the XLR jacks will send the signal coming from the input through the built-in crossover. You can also select the crossover frequency. The output signal should then be used to play the filtered frequencies with your standard full frequency speakers. When set to LINK, the crossover function is disabled.

2 INPUTS 1 AND 2

These combo inputs are designed for either TRS and XLR balanced plugs at line level either from a mixer or another speaker. The source can either be stereo or mono.

3 CROSSOVER LINK SELECTION SWITCH

Switches between the internal Crossover or the LINK mode to send the inputs directly to the outputs.

4 CROSSOVER SWITCH SELECTOR

This switch will determine the crossover point where the high pass filter will be set to output high frequency content to the outputs. The lower frequencies under the crossover point will be played by the internal speaker in the subwoofer.

5 LED DEFEAT SWITCH

The front-mounted LED has two functions. This switch toggles between those functions.

- ON position = Front-mounted LED indicates when power is on.
- S/L position = Front-mounted LED indicates when the limiter is engaged. (If LED turns red in this position, the speaker is distorting.)

6 PHASE SELECTION SWITCH

The Phase switch lets you alter the polarity of the input signal. When the Phase switch is in its default "0" setting, phase is unaffected.

7 LEVEL

This knob affects the volume of the internal speaker.

8 SIGNAL INDICATOR

The SIG/CLIP LED will light up BLUE when the speaker is receiving a signal. If it is distorting, the LED will turn RED and the MASTER VOLUME should be turned down.

9 POWER LED

The Power LED indicates that the V&Ri speaker's AC power cord is connected to an electrical outlet, and the Power Switch is turned on.

10 IEC POWER INPUT

Plug in the IEC AC cable here.

11 FUSE CARRIER

Main fuse housing.

12 POWER SWITCH

Turns the V&Ri subwoofer ON or OFF.

Connecting and Using NAXOS Loudspeakers

First things first!

1. Before connecting the power or signal cables, mount or position your NAXOS Loudspeaker where you intend to use or try it, do not carry it with any cables connected.

2. Set the MIC/LINE and BT/AUX input levels to minimum, the Master EQ controls to their mid positions, then connect the AC power and switch on the Loudspeaker.

Note: To prevent “thump” at power-on, NAXOS speakers use a Soft Start Power Supply incorporating a two second delay between switch-on and any indication of power.

3. Connect your source or host device as follows:-

Connecting a Dynamic Microphone or Wireless Microphone System:

1. Note: The MIC/LINE inputs of your NAXOS Loudspeaker will be set to LINE mode from new and will need to be switched to MIC mode.

2. Using a small screwdriver or similar implement, with care, switch your chosen MIC/LINE1 or MIC/LINE2 input to its “IN” position by gently pushing the recessed Line/Mic button. This will set the input to MIC mode.

3. Connect your microphone or wireless microphone receiver via the chosen TRS jack or XLR input of your NAXOS Loudspeaker.

4. Ensure that your wired microphone or wireless microphone system is switched on and that its volume control is not set to minimum.

5. Speak into the microphone while slowly increasing the level control of the corresponding MIC/LINE NAXOS input until you hear your voice in the speaker.

6. Always keep the microphone away from the speaker when using increased levels to avoid acoustic feedback squealing/howling.

Connecting a Sound Mixer:

1. The wired inputs of your NAXOS Loudspeaker will be set to LINE mode from new, therefore it should be ready for connection to a sound mixer. But this can be confirmed as described in the previous paragraph if required.

2. Connect your sound mixer to the Loudspeaker via its TRS jack or XLR inputs. Note: for stereo reproduction from a stereo source, you will require two matching BX Loudspeakers connected as one for each of the Left and Right stereo channels.

3. Ensure that your chosen sound mixer is outputting a signal and that its volume is not set to minimum.

4. Slowly increase the level control of the corresponding MIC/LINE inputs. You should hear music from the Loudspeaker.

Connecting a Laptop, Tablet or Smartphone by Cable:

1. Using the relevant cable, such devices can be connected by wire to any of the NAXOS Loudspeaker's inputs, but the most common way is to use a simple and readily available 3.5mm mini jack to mini jack stereo cable.

2. Connect one end of the mini jack cable to your desired device and the other end to the Aux input of the NAXOS Loudspeaker.

3. After ensuring that there is music playing on your device and that its volume is not set to minimum, slowly increase the BT/AUX, you should hear music from the Loudspeaker.

Connecting via Bluetooth:

1. Ensure that the Bluetooth on your chosen host device is turned on.

2. On your NAXOS Loudspeaker, long press the Pair button for 2 seconds, the Pair blue LED should begin to flash rapidly.

3. Refresh the Bluetooth of your host device and look for " NAXOS 10A DSP, NAXOS 12A DSP ,NAXOS 15A DSP" relevant to your NAXOS model, then pair and connect with it.

4. Once the connection has been established, the Pair blue LED of the Loudspeaker will remain lit continuously to indicate a successful connection.

5. Ensure that your host device is playing music and that its volume is not set to minimum.

6. When slowly increasing the level of the BT/AUX control of the Loudspeaker you should hear your source music.

TWS (True Wireless Stereo) Connectivity

When connecting your host device to a single NAXOS loudspeaker using Bluetooth, both the left and right channels of a stereo signal will be combined and played through the single Loudspeaker.

However, using two NAXOS Loudspeakers, the TWS function allows them both to be connected wirelessly as a stereo pair to the same host Bluetooth device as described below. This assumes that both Loudspeakers have been connected to AC power and are switched on.

Note: The NAXOS Loudspeaker first paired to your host device will become the Left stereo speaker.

1. Pair and connect the first NAXOS Loudspeaker to your host device as described in the previous paragraph (connecting via Bluetooth). This will become the Left speaker.

2. Switch on the second NAXOS Loudspeaker and set the BT/AUX level to minimum.
3. Long press the Pair button on the second Loudspeaker for 2 seconds, the Pair blue LED should begin to flash rapidly.
4. On both Loudspeakers, press the TWS button once, their TWS green LED's should begin to flash rapidly.
5. On the first Loudspeaker, press the TWS button once more, the TWS green LED's on both Loudspeakers should remain lit constantly to indicate a successful TWS connection. The Pair blue LED of the second speaker should no longer be lit.
6. Ensure that your host Bluetooth device is playing music and that its volume is not set to minimum.
7. When slowly increasing the level of the BT/AUX control of the Loudspeakers you should hear music from them both. The volume of both speakers can be controlled by your host device.

DSP Modes

Your NAXOS Series Loudspeaker incorporates a DSP (Digital Signal Processing) system which has 4 preset modes of equalisation (tone control) to suit your intended mode of operation. Pressing the Curve button on the DSP Parameter Control area of the panel will scroll through the available modes as follows:-

Standard – For general music or mixed voice/music reproduction use.

Vocal Boost – When using only microphones for public address.

Live – For live band music performances.

Stage Monitor – When using the loudspeaker horizontally in stage monitor applications

Bass and Treble adjustment

The Bass and Treble controls are provided for additional adjustment of the equalisation where required and are effective using all inputs of the speaker. The Line Out XLR connection is not affected by the Bass and Treble settings.

Note: When increasing the desired volume level, it is possible to reach an overload situation sooner as a result of a higher Bass setting or excessive bass content in music. This can be improved by reducing the Bass level control of your NAXOS Loudspeaker.

Linking Speakers by Wire

NAXOS Loudspeakers can be linked together by connecting the LINE OUT of one

Loudspeaker (the master) to a MIC/LINE input of the next (the slave) using an XLR female to male or XLR female to jack cable. Several speakers can be connected together in this way if required.

Note: When linking by wire, the MIC/LINE input of the slave speaker must be set to LINE mode as described previously. Also, this configuration will not enable true stereo operation.

Overload Warning

NAXOS Loudspeakers incorporate some degree of overload protection, but over driving is still possible and can cause severe damage to the Loudspeaker. Such damage is not covered by warranty and correct use remains the responsibility of the user.

The SIG/LIMIT LED on the upper right of the amplifier panel will light or may flicker Green to indicate the presence of an input signal during normal use.

However, should it light RED, this is an indication of excessive input signal or that the Loudspeaker is being over driven. In this case, the signal level from the connected device and/or the respective MIC/LINE or BT/AUX level must immediately be reduced to avoid damage to the Loudspeaker.

Transporting, Mounting and Installing BX Loudspeakers

The NAXOS 10A DSP Loudspeaker has a top carrying handle and the NAXOS 12A DSP and NAXOS 15A DSP models have side and top carrying handles.

For safety they should only be carried using these handles. The cabinets are robust but they must be lifted, handled and placed onto hard surfaces with care. All models can be mounted onto a standard 35mm pole using the integral receptacle in the cabinet base with hand locking hand bolt. Two M6 points are provided in the top of the NAXOS 10A DSP cabinet and M8's in the top and bottom of the NAXOS 12A DSP and NAXOS 15A DSP. All fixing points are covered by easily removable cosmetic caps during production.

Care and Maintenance

No adjustment or maintenance of NAXOS Loudspeakers is necessary and cleaning should only be done using a dry, non-abrasive cloth or dry dusting brush.

Warranty

NAXOS Series Loudspeakers are warranted in the EU only for one year from the date of supply or delivery against faulty parts or manufacturing defects. The warranty excludes electrical or mechanical faults or damage as a result of over driving by excessive input signal, excessive AC voltage, abuse, misuse, or failure to observe the operating guidelines detailed in this manual.

Specifications* (see note below)

Model	NAXOS 10A DSP	NAXOS 12A DSP	NAXOS 15A DSP
Inputs	Bal XLR/TRS 6.35/ AUX/ Bluetooth	Bal XLR/TRS 6.35/ AUX/ Bluetooth	Bal XLR/TRS 6.35/ AUX/ Bluetooth
Outputs	Balanced XLR / TWS	Balanced XLR / TWS	Balanced XLR / TWS
Power output	150W (LF) + 50W (HF) RMS	250W (LF) + 50W (HF) RMS	250W (LF) + 50W (HF) RMS
Bluetooth version	5.0	5.0	5.0
Power input	100V/240V ~50/60Hz switchable	100V/240V ~50/60Hz switchable	100V/240V ~50/60Hz switchable
Features	LF:CLASS-D HF:CLASS-AB	LF:CLASS-D HF:CLASS-AB	LF:CLASS-D HF:CLASS-AB
Signal processing	DSP	DSP	DSP
DSP Parameter	Standard/Vocal Boost/ Live/Stage monitor	Standard/Vocal Boost/ Live/Stage monitor	Standard/Vocal Boost/ Live/Stage monitor
EQ	Bass/Treble	Bass/Treble	Bass/Treble
Frequency Range	60-20K Hz	55-20K Hz	45-20K Hz
Max output SPL	123dB (at max AMP output)	125dB (at max AMP output)	126dB (at max AMP output)
Impedance	LF 4Ω/HF 8Ω	LF 4Ω/HF 8Ω	LF 4Ω/HF 8Ω
Driver	1" Compression driver	1.35" Compression driver	1.35" Compression driver
Woofers	10" Driver	12" Driver	15" Driver
Cabinet	HPP moulded cabinet	HPP moulded cabinet	HPP moulded cabinet
Fuse	T3.15AL/250V	T3.15AL/250V	T3.15AL/250V
Pole mount	35mm stand pole	35mm stand pole	35mm stand pole
Dims / Weight	395x365x565mm / 12kg	460x430x660mm / 17.5kg	530x500x765mm / 22.2kg

	NAXOS 18A SUB	
Amplifier	Inputs	2 XLR / TRS LINE input
	Outputs	2 XLR line output
	Power Output	500 w/RMS @ 8 Ohms / 1500 Watts Peak
	Volume	Main volume control
	Power Input	100V/240V ~50/60Hz switchable
	Features	Class D+ switching power design
		Phase switchable (0/180°)
LED power/signal/clip indicator		
Crossover design for satellite (90Hz or120Hz)		
Speaker	Type	Active vented subwoofer
	Frequency Response	35-150Hz
	Max Output SPL	125dB
	Impedance	8 Ohm
	Woofer	18" subwoofer, 3" VC 85oZ (MA18SW)
	Cabinet	Plywood with black painted finish
	Grille	1.5mm steel
	Pole	35mm stand pole
	Features	Rubber corner to protect the edge
Packaging Information	Packaging Size	740mm x 635mm x 765mm
	Net Weight	44 kg

***NOTE:** IGHOS products are subject to a process of continuous development and improvement. Therefore, actual specifications may change without notice and may also differ from those printed in this user manual.

Troubleshooting

No sound from the loudspeaker	A · Check that the AC power cord is securely connected to a known live outlet which is switched ON.
	B · Make that all input cables are connected and that source device is playing and its volume is not set to minimum.
	C · Make sure the relevant input control of the loudspeaker volume is not set to minimum.
Loudspeaker has hum or buzz	A · Check the input source device is playing, correctly connected and that its volume is not set to minimum.
	B · If a microphone is connected, turn down the speaker input level and try disconnecting then reconnecting the microphone.
	C. Is there a faulty cable or connector? Try gently moving each one in turn and check if the hum or buzz changes.
No sound or low volume from the Microphone	A · Make sure the Microphone or microphone system is switched on.
	B · Check that the relevant Mic / Line input of the loudspeaker is switched to Mic
	C · Try adjusting the MIC/LINE level of the loudspeaker or external volume level of the microphone or microphone system.
Squealing, howling, or distorted sound from the Microphone	A · Try reducing the MIC/LINE level of the loudspeaker or external volume level of the microphone or microphone system.
	B · Move the microphone away from, or out of direct line of the loudspeaker.
	C · Try reducing the Master EQ Treble control of the loudspeaker.
Sound breaks up intermittently or is distorted	A · The input level may be too high causing the SIG/LIMIT LED to light RED – Try reducing the all level controls.
	B · Is there a faulty cable or connector? Try gently moving each one in turn and check if the hum or buzz changes.

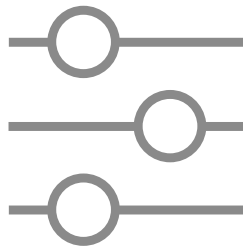

IHOS
INTELLIGENT AUDIO

www.i-hos.eu
sales@i-hos.eu

