



ARU204

Multi-channel digital relay unit - 4 relays

Highlights:

- Compatible with AUDAC Touch™ 2
- Remote control web interface (HTML5)
- DIN rail mounting enclosure
- RS485 & TCP/IP controllable
- Pre-programmed timed relay triggering
- Terminal block connection (In- and output)
- Double pole relays with Normal Open (NO) and Normal Closed (NC) contacts

The ARU204 is specially designed with flexibility and functionality in mind. Various ways of switching the 4 relays are provided, these include the integrated web interface, optional paging consoles and analogue contact triggering making the ARU204 AUDAC's smartest and most innovative relay modules.

With this ingenious device, switching between audio sources, signal routing, and even customized automation setups are obtainable. The bipolar relays allow switching of balanced mono signals as well as unbalanced stereo signals. Normal open and normal closed contacts are provided as well. A wide variation of signals can be switched, ranging from line-level audio signals to amplified loudspeakers signals (Low impedance or 100V) and voltage distribution (low voltage up to 240 V AC mains voltage distribution).

Possibility for triggering relays through dry contact inputs, which can be used for triggering relays through external devices or actuators. Dry contacts priority over the digital functions/triggers. Typical applications are activations by external buttons, switches or alarm contacts.

Thanks to its modular nature, the ARU204 is perfectly suitable for small home or retail applications as well as big installations. Integration of numerous ARU20x units in one system is possible due to the RS485 which allows daisy-chaining of multiple units. The ARU208 features an RS485 in and output connector, allowing even more convenient connections. The TCP/IP control possibilities allow integration of the ARU20x's in any ethernet network. The integrated web-browser running an HTML5 interface allows the most flexible and complete operation while the freely available command set allows integration with any TCP/IP based control or automation system.

The front of the black ABS housing provides a brief overview of its connection possibilities, while the back is equipped with a spring mount mechanism allowing easy mounting on widely available standard DIN rails. This way it's possible to easily integrate it in any electrical cabinet where it can be powered using the optional PSD24x power supply.

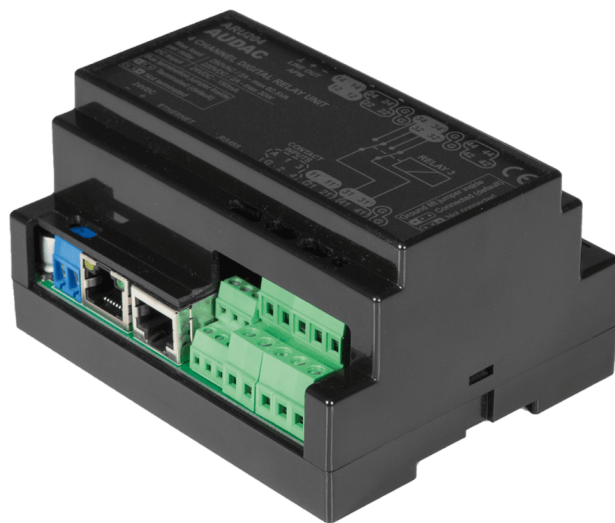



System specifications:

Number of relays		4
Contacts		Normal open & normal closed
Control		Digital communication bus (RS-485)
		Manual (contact) relay activation
		TCP/IP
		Audac Touch™
Connectors		RJ45 (Ethernet)
		1 x RJ45 (RS-485 + Audio)
Max. cable length		300 m
Connection standard		TIA/EIA T568B
Relay	Type	Two pole type
Inputs	Signal	8 x 3-pin screw terminal for A & B input
Outputs	Signal	8 x 2-pin screw terminal
Power	Consumption	6 W (max.)
	Supply	24 V DC

Product Features:

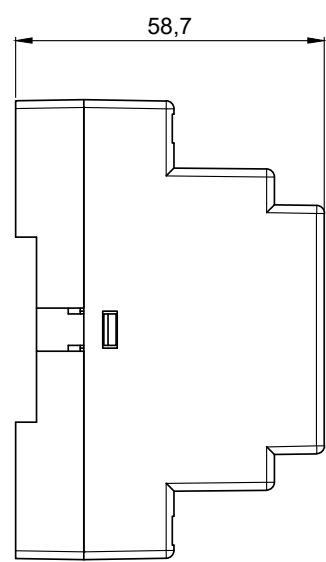
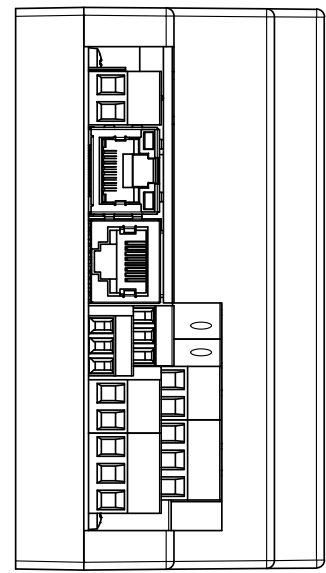
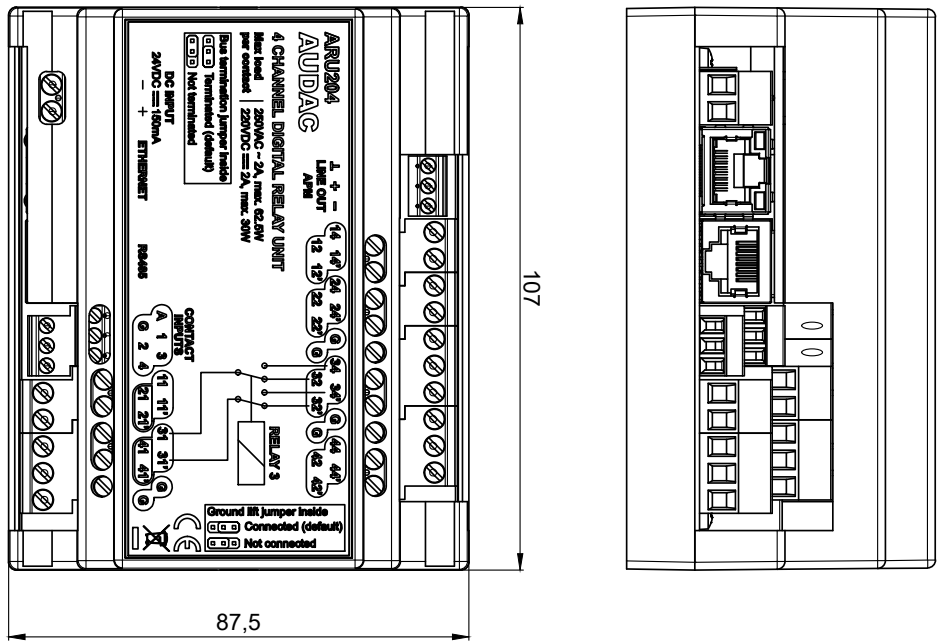
Dimensions		107 x 87.5 x 54 mm (W x H x D)
Weight		0.2 kg
Data protocol		RS-485
Required cabling		UTP CAT5E
Colours		Black
Construction		ABS
Accessories	Optional	PSD24x external Power supply



	
ARU204	Product description: 4 CHANNEL DIGITAL RELAY UNIT - RS485 & TCP/IP - EXTRA LOW VOLTAGE - DPDT - DIN RAIL
Weight:	0,2 kg
Outer dimensions: (w x h x d)	107 x 87,5 x 58,7
Unit height:	N/A